

Galloway Retail Center

Prime Location Retail Center in Pontiac, MI



51863 Schoenherr Road
Suite 102, Shelby Township,
MI 48315

Phone: 586-228-2232

Fax: 586-846-4577

Email:

LarryHoward19@GMail.com

JordanHowardHRG@GMail.com

General Information:

- **SITE ADDRESS:** 1602-1648 N. Perry Rd. Pontiac, MI
- **Total Structure Size:** 49,246 Square Feet
- **Great Location / High Visibility**
- **Negotiable Rates**
- **Convenient Parking Spaces**
- **Near I-75 freeway**
- **Current Tenants:** Flagstar Bank, Metro PCS, Jade Nails, LA Insurance and Others.

LEASE PLAN-OVERVIEW



51863 Schoenherr Road
Suite 102, Shelby Township,
MI 48315

Phone: 586-228-2232

Fax: 586-846-4577

Email:

LarryHoward19@GMail.com

JordanHowardHRG@GMail.com

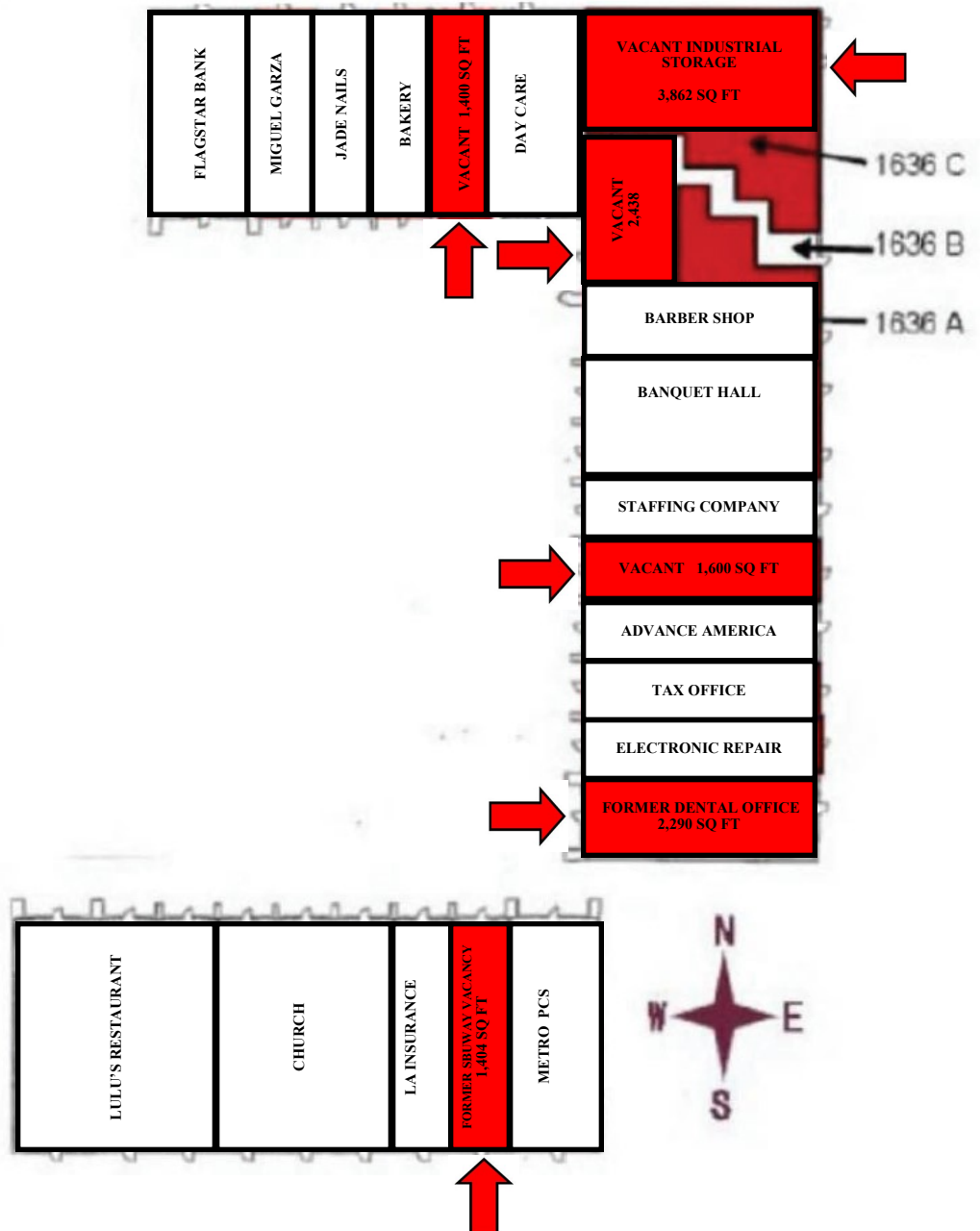

MAPS

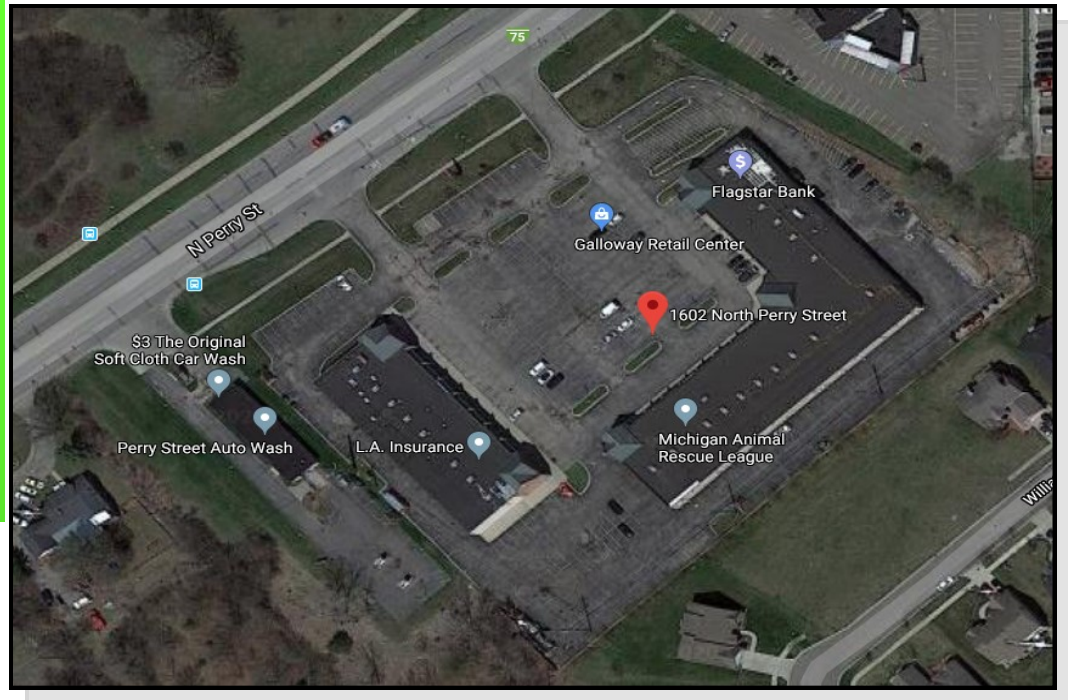

51863 Schoenherr Road
Suite 102, Shelby Township,
MI 48315

Phone: 586-228-2232

Fax: 586-846-4577

Email:

LarryHoward19@GMail.com

JordanHowardHRG@GMail.com

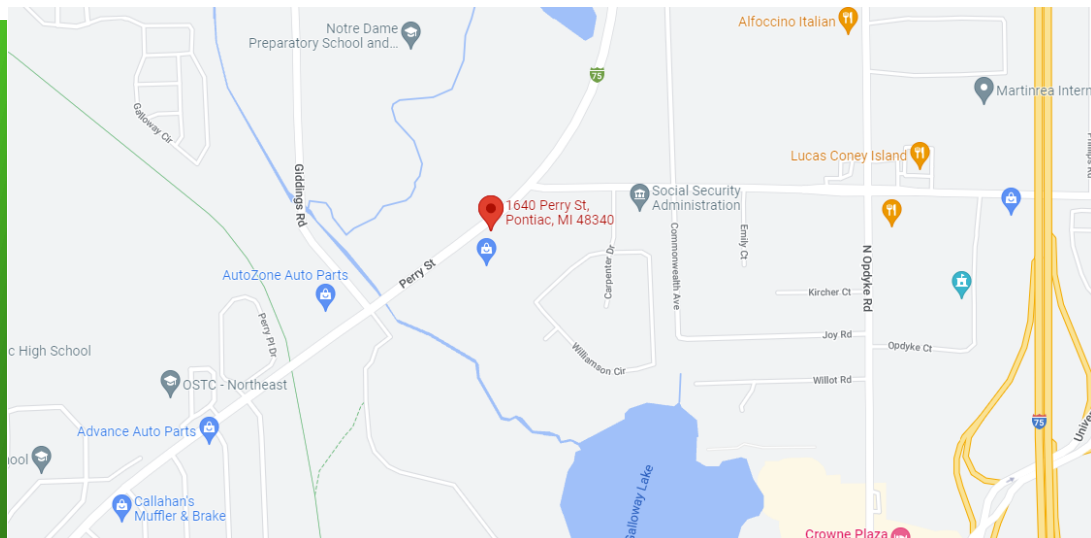

WEBSITE : www.HRGproperty.com